

REVISIONS
31.05.19 Rev A Updated as per feedback

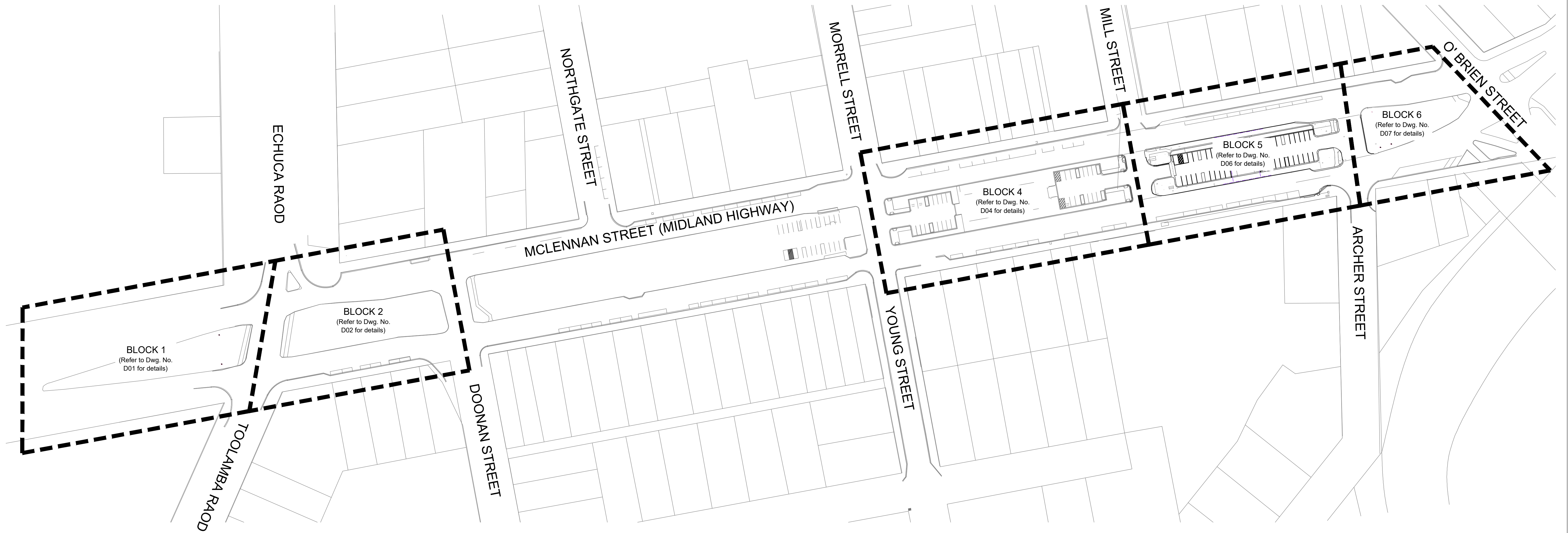

DRAWING INDEX

Dwg. No. D00	Cover Sheet
Dwg. No. D01	Block 1 Landscape Plan
Dwg. No. D02	Block 2 Landscape Plan
Dwg. No. D03	Block 2 Landscape Detail Plan
Dwg. No. D04	Block 4 Landscape Plan
Dwg. No. D05	Block 4 Landscape Detail Plan
Dwg. No. D06	Block 5 Landscape Plan
Dwg. No. D07	Block 5 Landscape Detail Plan
Dwg. No. D08	Block 6 Landscape Plan
Dwg. No. D09	Block 6 Landscape Detail Plan
Dwg. No. D10	Street Furniture
Dwg. No. D11	Landscape Details #1
Dwg. No. D12	Landscape Details #2

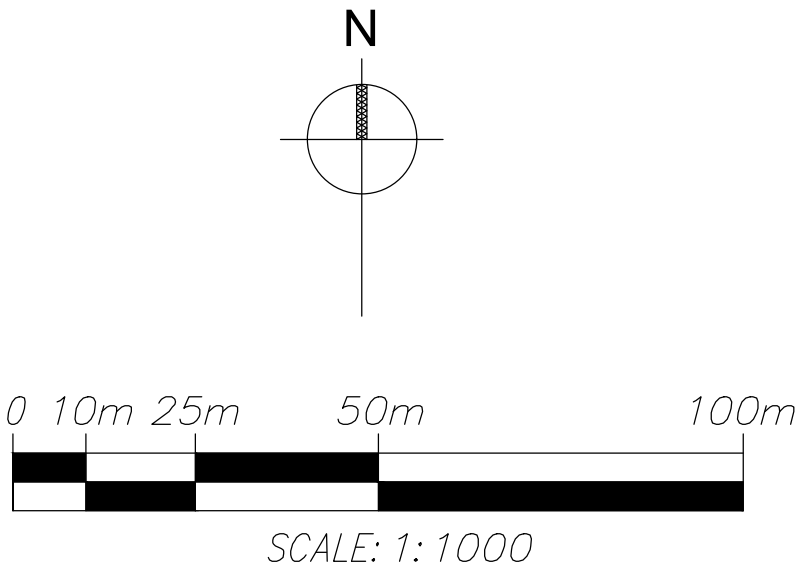

NOTE: base plan data compiled from drawings provided by GSCC & aerial photo sourced from Nearmap - date flown October 22, 2018.



Project:
Block 1, 2, 4, 5 & 6
McLennan Street, Mooroopna

Drawing Title:
Cover Sheet

Prepared for:
Greater Shepparton City Council

Date: May 31, 2019
Scale: 1:1000 @ A1 sheet size
Drawn: HM & YL
Checked: DH
Drawing No: 1862-D00

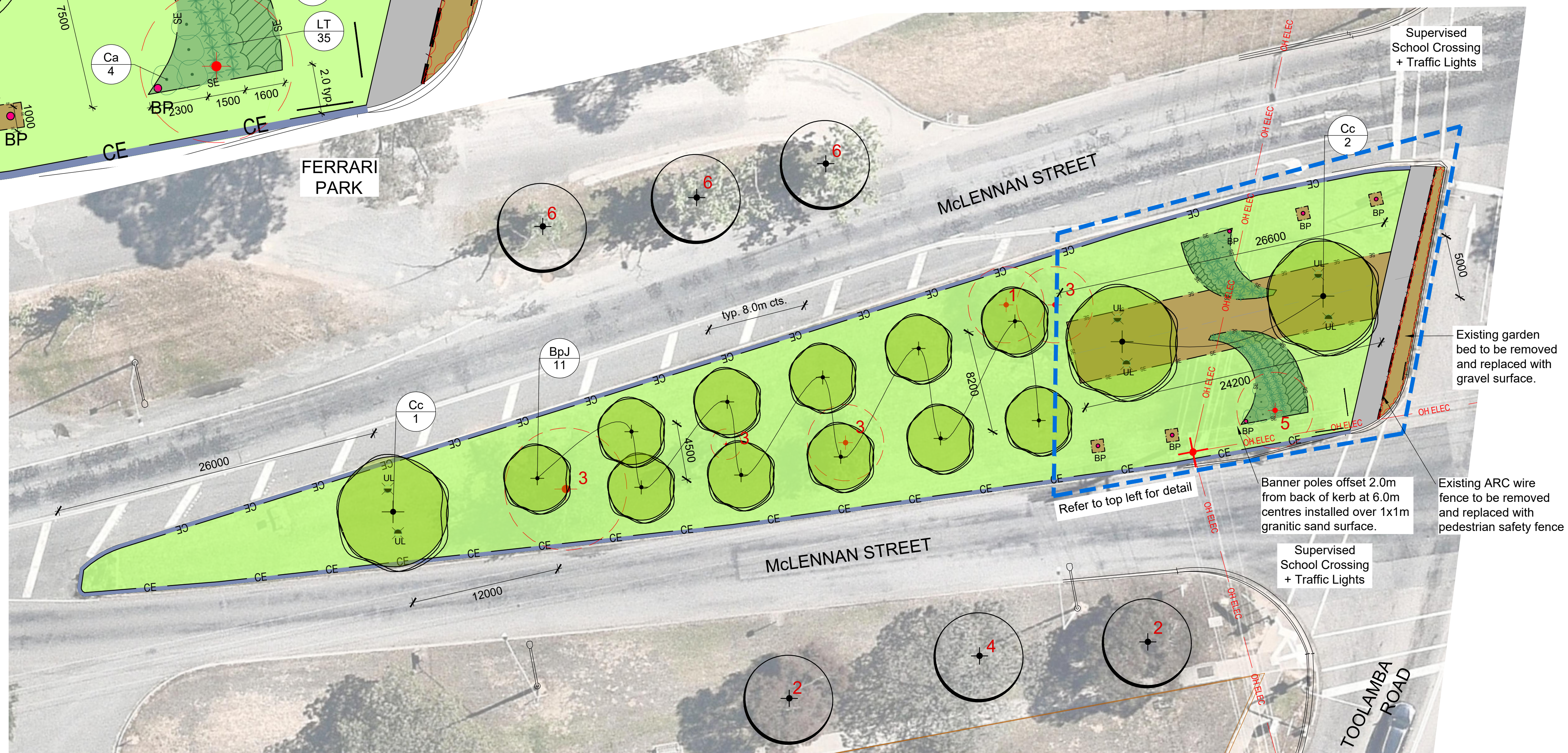
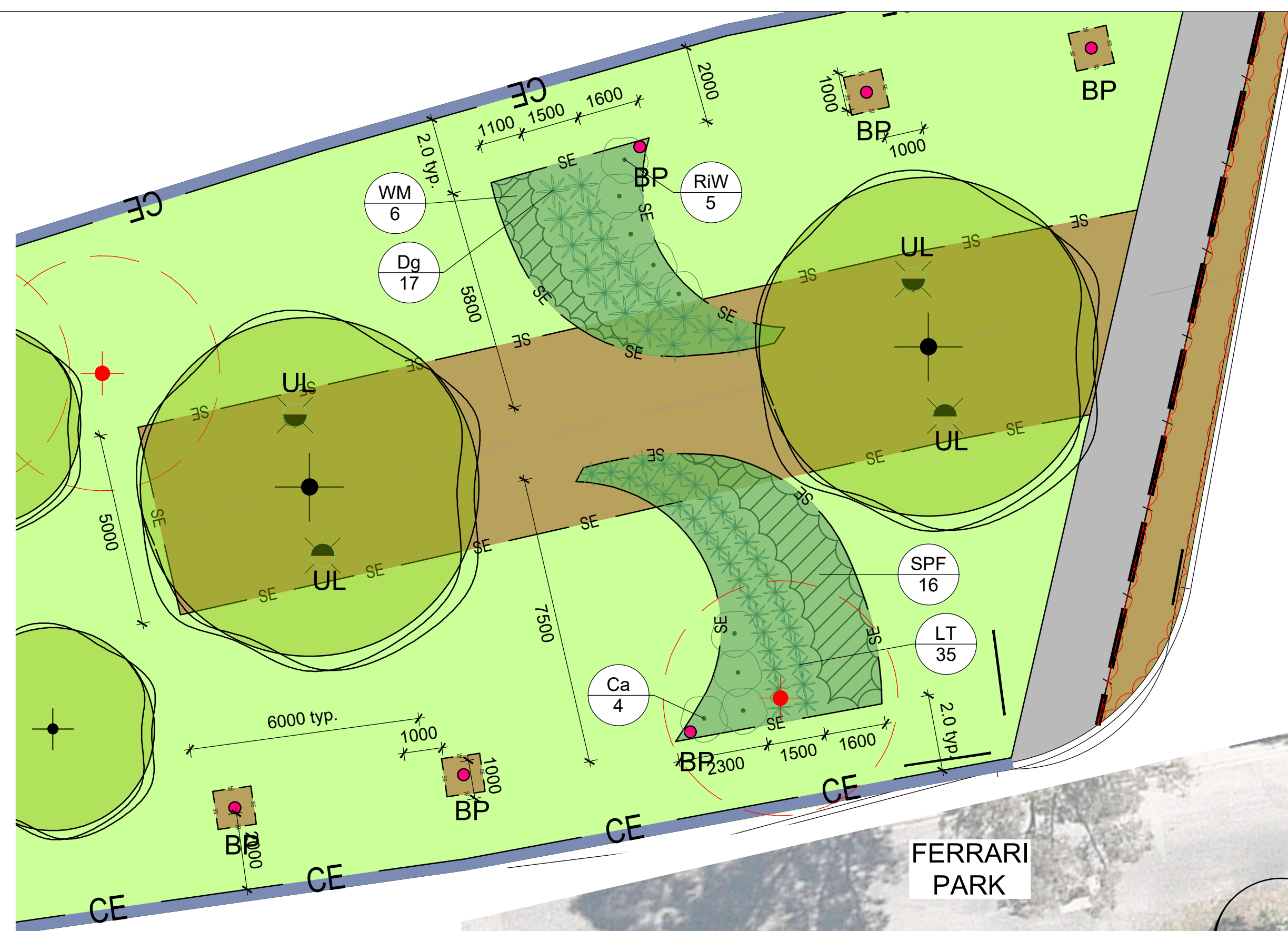
REFERENCE NOTES SCHEDULE BLOCK 1



















<u>SYMBOL</u>	<u>DESCRIPTION</u>
1	Cinnamomum camphora / Camphor Laurel
2	Eucalyptus sp. / Gum
3	Liquidambar styraciflua / American Sweetgum
4	Melia azedarach / White Cedar
5	Melaleuca sp. / Paperbark
6	Platanus x acerifolia / London Plane Tree

PLANT SCHEDULE BLOCK 1

<u>TREES</u>	<u>BOTANICAL NAME</u>	<u>COMMON NAME</u>	<u>MATURE SIZE (H X W)</u>	<u>INSTALLATION SIZE</u>	<u>DENSITY</u>	<u>QTY</u>
BpJ	Brachychiton populneus `Jerilderie Red`	Bottle Tree ctv.	8 x 7m	45L, 1.5m high, 30mm cal.	As shown	11
Cc	Corymbia citriodora	Lemon Scented Gum	25 x 12m	45L, 1.5m high, 30mm cal.	As shown	3
<u>SHRUBS</u>	<u>BOTANICAL NAME</u>	<u>COMMON NAME</u>	<u>MATURE SIZE (H X W)</u>	<u>INSTALLATION SIZE</u>	<u>DENSITY</u>	<u>QTY</u>
Ca	Correa alba	White Correa	1.5 x 1.5m	140mm container	1.5m cts.	4
RiW	Rhaphiolepis indica `Cosmic White`	Indian Hawthorn - White Fl.	1.5 x 1.5m	140mm container	1.0m cts.	5
<u>BLADED PLANT</u>	<u>BOTANICAL NAME</u>	<u>COMMON NAME</u>	<u>MATURE SIZE (H X W)</u>	<u>INSTALLATION SIZE</u>	<u>DENSITY</u>	<u>QTY</u>
Dg	Dietes grandiflora	Wild Iris	1 x 1m	140mm container	0.75m cts.	17
LT	Lomandra `Tanika`	Lomandra ctv.	0.6 x 0.6m	140mm container	0.5m cts.	35
<u>GROUND COVERS</u>	<u>BOTANICAL NAME</u>	<u>COMMON NAME</u>	<u>MATURE SIZE (H X W)</u>	<u>INSTALLATION SIZE</u>	<u>DENSITY</u>	<u>QTY</u>
SPF	Scaevola humilis `Purple Fusion` TM	Purple Fusion Scaevola	0.2 x 1.5m	140mm container	0.75m cts.	16
WM	Westringia fruticosa `Mundi` TM	Low Coastal Rosemary	0.5 x 1.5m	140mm container	0.75m cts.	6

REVISIONS
31.05.19 Rev A Updated as per feedback

LEGEND

- | | |
|--|--|
|  | Tree to be retained
refer to schedule for details |
|  | Tree to be removed
refer to schedule for details |
|  | Existing concrete
pavement |
|  | Existing overhead
powerlines and poles |
|  | Existing light pole |
|  | Demolition |
|  | Grass area |
|  | Proposed garden bed |
|  | Proposed tree planting |
|  | Proposed shrub |
|  | Proposed bladed plant |
|  | Proposed groundcover |
|  | Proposed 300mm concrete
mower strip behind kerb |
|  | Proposed steel edging
to garden bed |
|  | Proposed pedestrian
safety fence |
|  | Proposed gravel surface
with steel edging |
|  | Proposed up light to tree |
|  | Proposed banner pole |

Scale 1:200 @ A1



0 2 4 8m



Project:
Block 1, 2, 4, 5 & 6
McLennan Street, Mooroopna

Drawing Title:
Block 1 Landscape Plan

Prepared for:
Greater Shepparton City Council

Date: May 31, 2019
Scale: Refer to Scale @ A1 sheet size
Drawn: HM & YL
Checked: DH
Drawing No: 1862-D01

THOMSON HAY
LANDSCAPE ARCHITECTS

 **DIAL1100**
BEFORE YOU DIG

NOTE: base plan data compiled from drawings provided by GSCC & aerial photo sourced from Nearmap - date flown October 22, 2018.

I30 Howards Rd, Wattle Flat VIC 3352
T 03 5334 5321 W www.thomsonhay.com



Block 4 Set Out + Planting Plan
Scale 1:200 @ A1

REFERENCE NOTES SCHEDULE BLOCK 4

SYMBOL	DESCRIPTION
1	Cinnamomum camphora / Camphor Laurel
9	Malus ioensis 'Plena' / Bechtel Crab Apple
10	Pyrus calleryana / Ornamental Pear

Note:
Refer to Dwg. No. 1862-D05 for Block 4 Plant Schedule.

LEGEND

- Existing over head powerlines and poles
- Existing up light to tree
- Existing post top light
- Existing underground service pit
- Existing irrigation controller
- Existing traffic bollard
- Existing rubbish bin

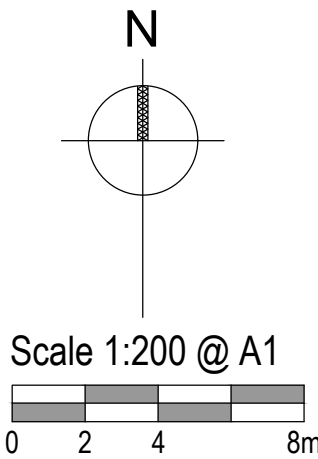

NOTE: base plan data compiled from drawings provided by GSCC & aerial photo sourced from Nearmap - date flown October 22, 2018.



REVISIONS
31.05.19 Rev A Updated as per feedback

LEGEND

- Proposed tree planting
- Tree to be retained refer to schedule for details
- Existing tree to be removed refer to schedule for details
- Existing asphalt pavement
- Existing ARC wire fence
- Toilet block
- Existing picnic table / seat
- Paving / structure / garden bed to be demolished
- Existing garden bed
- Proposed garden bed
- Grass area
- Proposed shrub
- Proposed bladed plant
- Proposed groundcover
- Proposed 300mm concrete mower strip behind kerb
- Proposed steel edging to garden bed
- Proposed gravel surface with steel edging
- Proposed concrete paving with exposed aggregate
- Proposed pedestrian safety fence
- Proposed picnic table / bench seat
- Proposed low seating wall



Project:
Block 1, 2, 4, 5 & 6
McLennan Street, Mooropna

Drawing Title:
Block 4 Landscape Plan

Prepared for:
Greater Shepparton City Council

Date: May 31, 2019
Scale: 1:200 @ A1 sheet size
Drawn: HM
Checked: DH
Drawing No: 1862-D04



LEGEND

- Proposed tree planting
- Tree to be retained refer to schedule for details
- Existing tree to be removed refer to schedule for details
- Existing garden bed
- Proposed garden bed with steel edging
- Grass area
- Proposed 300mm concrete mower strip behind kerb
- Proposed gravel surface with exposed aggregate
- Existing over head powerlines and poles
- Proposed concrete paving with exposed aggregate
- Proposed pedestrian safety fence
- Proposed picnic table / bench seat
- Proposed post top light
- Paving / structure / garden bed to be demolished
- Proposed fixed bollard
- Proposed root barrier

Note: refer to Engineering plans prepared by Tomkinson for details of civil works.

Scale 1:200 @ A1
0 2 4 8m



Project:
Block 1, 2, 4, 5 & 6
McLennan Street, Mooroopna

Drawing Title:
Block 5 Landscape Plan

Prepared for:
Greater Shepparton City Council

Date: May 31, 2019
Scale: 1:200 @ A1 sheet size
Drawn: HM
Checked: DH
Drawing No: 1862-D06

THOMSON HAY
LANDSCAPE ARCHITECTS

130 Howards Rd, Wattle Flat VIC 3352
T 03 5334 5321 W www.thomsonhay.com



NOTE: base plan data compiled from drawings provided by GSCC & aerial photo sourced from Nearmap - date flown October 22, 2018.

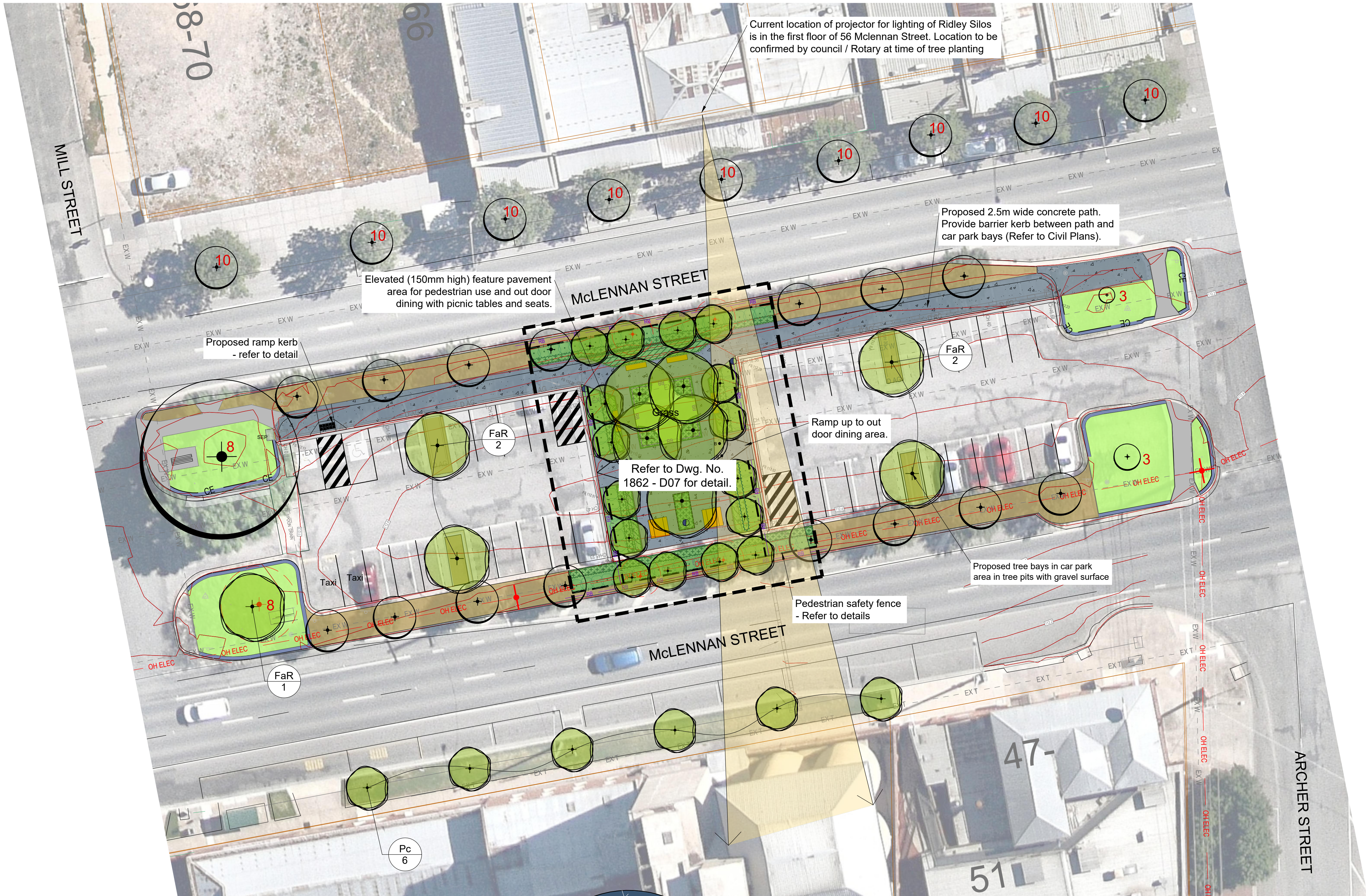
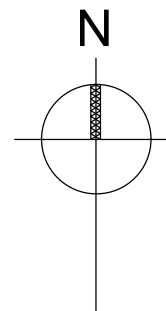

REFERENCE NOTES SCHEDULE BLOCK 5

SYMBOL	DESCRIPTION
3	Liquidambar styraciflua / American Sweetgum
8	Fraxinus angustifolia 'Raywood' / Claret Ash
10	Pyrus calleryana / Ornamental Pear

PLANT SCHEDULE BLOCK 5

TREES	BOTANICAL NAME	COMMON NAME	MATURE SIZE	INSTALLATION SIZE	DENSITY	QTY
FaR	Fraxinus angustifolia 'Raywood'	Claret Ash	12 x 9m	45L, 1.5m high, 30mm cal.	As shown	5
LiT	Lagerstroemia indica x fauriei 'Tuscarora'	Tuscarora Crape Myrtle	5 x 4m	45L, 1.5m high, 30mm cal.	1.0m cts.	16
Pc	Pyrus calleryana	Ornamental Pear	10 x 5m	45L, 1.5m high, 30mm cal.	As shown	6
UpT	Ulmus parvifolia 'Todd'	Chinese Elm ctv.	10 x 11m	45L, 1.5m high, 30mm cal.	2.0m cts.	5
SHRUBS	BOTANICAL NAME	COMMON NAME	MATURE SIZE	CONTAINER	DENSITY	QTY
RiW	Rhaphiolepis indica 'Cosmic White'	Indian Hawthorn - White Fl.	1.5 x 1.5m	140mm container	1.0m cts.	71
SHRUB AREAS	BOTANICAL NAME	COMMON NAME	MATURE SIZE	CONTAINER	DENSITY	QTY
Dg	Dietes grandiflora	Wild Iris	1 x 1m	140mm container	0.75m cts.	96
LT	Lomandra 'Tanika'	Lomandra ctv.	0.6 x 0.6m	140mm container	0.5m cts.	15
GROUND COVERS	BOTANICAL NAME	COMMON NAME	MATURE SIZE	CONTAINER	DENSITY	QTY
TaF	Trachelospermum asiaticum 'Flat Mat'	Asiatic Jasmine ctv.	0.25 x 0.7m	140mm container	0.75m cts.	24
WM	Westringia fruticosa 'Mundi' TM	Low Coastal Rosemary	0.5 x 1.5m	140mm container	0.75m cts.	27



Cut out 2 x 2m concrete pavement for the tree planting. Break up existing sub-soil to a depth of 600mm and remove any unsuitable material and replace with approved fresh top soil.

Block 6 Set Out + Planting Plan
Scale 1:200 @ A1

REFERENCE NOTES SCHEDULE BLOCK 6

SYMBOL	DESCRIPTION
3	Liquidambar styraciflua / American Sweetgum
6	Platanus x acerifolia / London Plane Tree
10	Pyrus calleryana / Ornamental Pear
12	Crataegus sp. / Hawthorn

PLANT SCHEDULE BLOCK 6

TREES	BOTANICAL NAME	COMMON NAME	MATURE SIZE	INSTALLATION SIZE	DENSITY	QTY
BpJ	Brachychiton populneus 'Jerilderie Red'	Bottle Tree ctv.	8 x 7m	45L, 1.5m high, 30mm cal.	As shown	5
Cc	Corymbia citriodora	Lemon Scented Gum	25 x 12m	45L, 1.5m high, 30mm cal.	As shown	2
Pc	Pyrus calleryana	Ornamental Pear	10 x 5m	45L, 1.5m high, 30mm cal.	As shown	11
SHRUBS	BOTANICAL NAME	COMMON NAME	MATURE SIZE	CONTAINER	DENSITY	QTY
Ca	Correa alba	White Correa	1.5 x 1.5m	140mm container	1.5m cts.	8
RIW	Rhaphiolepis indica 'Cosmic White'	Indian Hawthorn - White Fl.	1.5 x 1.5m	140mm container	1.0m cts.	10
BLADED PLANT	BOTANICAL NAME	COMMON NAME	MATURE SIZE	CONTAINER	DENSITY	QTY
Dg	Dietes grandiflora	Wild Iris	1 x 1m	140mm container	0.75m cts.	51
LT	Lomandra 'Tanika'	Lomandra ctv.	0.6 x 0.6m	140mm container	0.5m cts.	57
GROUND COVERS	BOTANICAL NAME	COMMON NAME	MATURE SIZE	CONTAINER	DENSITY	QTY
SPF	Scaevola humilis 'Purple Fusion' TM	Purple Fusion Scaevola	0.2 x 1.5m	140mm container	0.75m cts.	34
WM	Westringia fruticosa 'Mundi' TM	Low Coastal Rosemary	0.5 x 1.5m	140mm container	0.75m cts.	24

REVISIONS
31.05.19 Rev A Updated as per feedback

LEGEND	
	Tree to be retained refer to schedule for details
	Existing tree to be removed refer to schedule for details
	Existing concrete pavement
	Existing over head powerlines and poles
	Existing light pole
	Existing up light to tree
	Existing electrical meter box
	Existing irrigation controller
	Existing underground service pit
	Existing street signage
	Demolition
	Grass area
	Proposed garden bed
	Proposed tree planting
	Proposed shrub
	Proposed bladed plant
	Proposed groundcover
	Proposed 300mm concrete mower strip behind kerb
	Proposed steel edging to garden bed
	Proposed gravel surface with steel edging



Project:
Block 1, 2, 4, 5 & 6
McLennan Street, Mooroopna

Drawing Title:
Block 6 Landscape Plan

Prepared for:
Greater Shepparton City Council

Date: May 31, 2019
Scale: 1:200 @ A1 sheet size
Drawn: HM
Checked: DH
Drawing No: 1862-D08

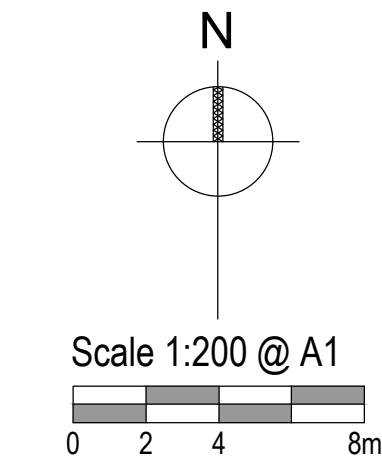

NOTE: base plan data compiled from drawings provided by GSCC & aerial photo sourced from Nearmap - date flown October 22, 2018.