

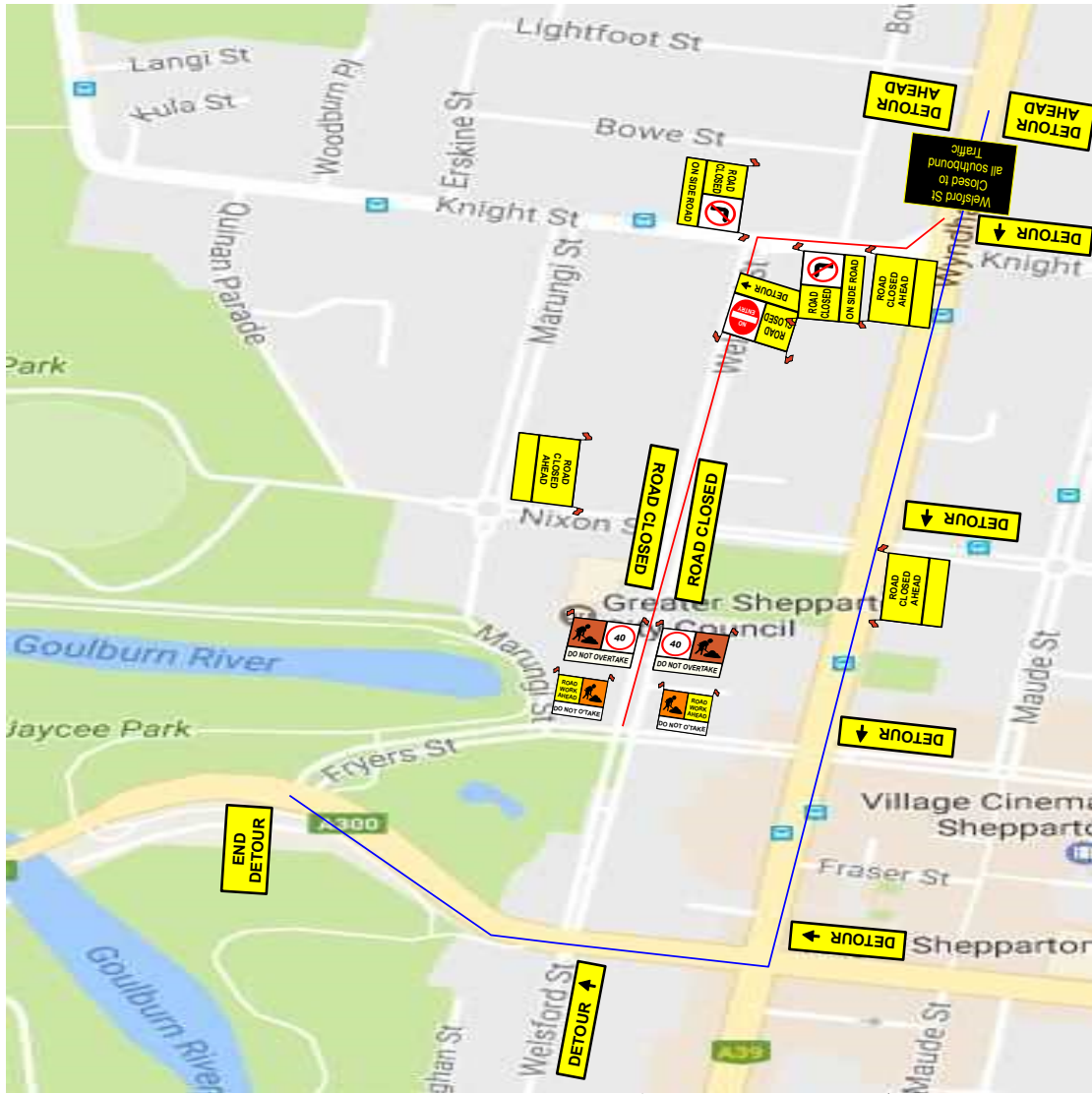





South Detour
North Detour



 <p>TRAFFIC & CONTRACTING</p> <p>98 Drummond Rd Shepparton 3630 03 5822 0861</p>	<p>Date: 13/4/2017</p> <p>Client: Mawsons</p> <p>Job Location: Welsford St Shepparton</p>	<p>Drawn by: Colin Colger</p> <p>TMP Number G17-033</p> 	 <p>Pedestrian signage will be used when works extend to the footpath. Take bollards and tape for pedestrian management.</p>	<p>Please Note</p>  <p>Existing Speed Signs to be covered for duration of works and reinstated at end of works</p>  <p>Side streets entering speed restricted zone must be signed with the above sign.</p>	<p>Notes</p> <ol style="list-style-type: none">Where speed signs are incorporated in m/m board that are duplicated, the speed sign will always be nearest the road.The location of signs shown on this plan may be varied slightly during implementation to improve visibility and effectiveness.All redundant speed signs to be coveredAfter installation a drive-through inspection is to be conducted and signs adjusted for maximum effectiveness.All signage used will be in accordance with AS 1742.3-2009GAME takes no responsibility of plan if not implemented by GAMEPlan not to Scale	<p>Comments: Upgrade of Welsford St</p>
---	--	---	--	---	---	--