

Proposed plaza design is conceptual only.
This design has been shown for discussion purposes only.
All elements are subject to change during consultation and design development.

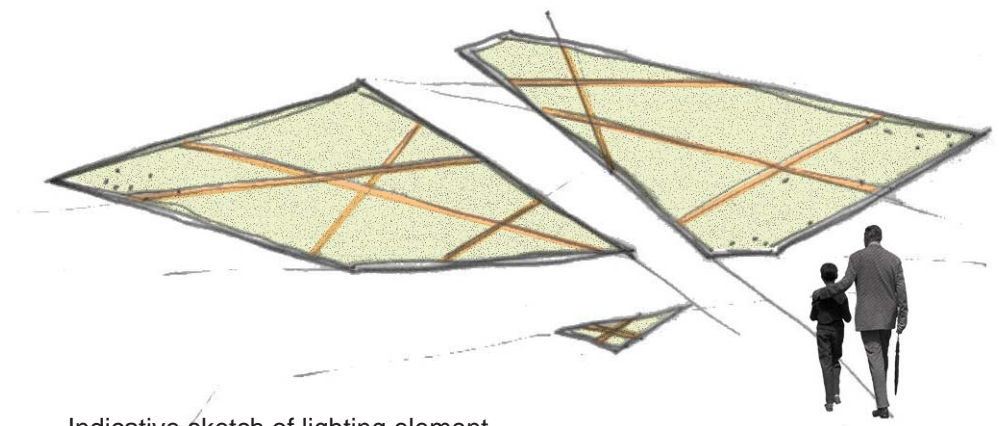
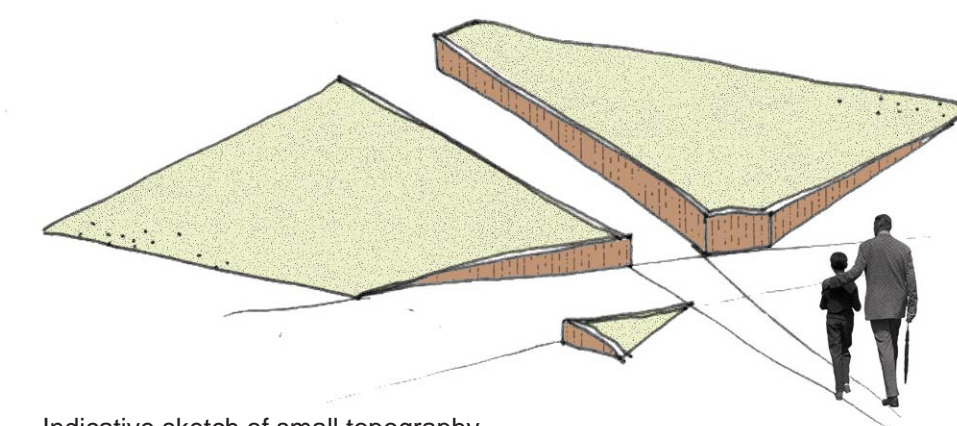
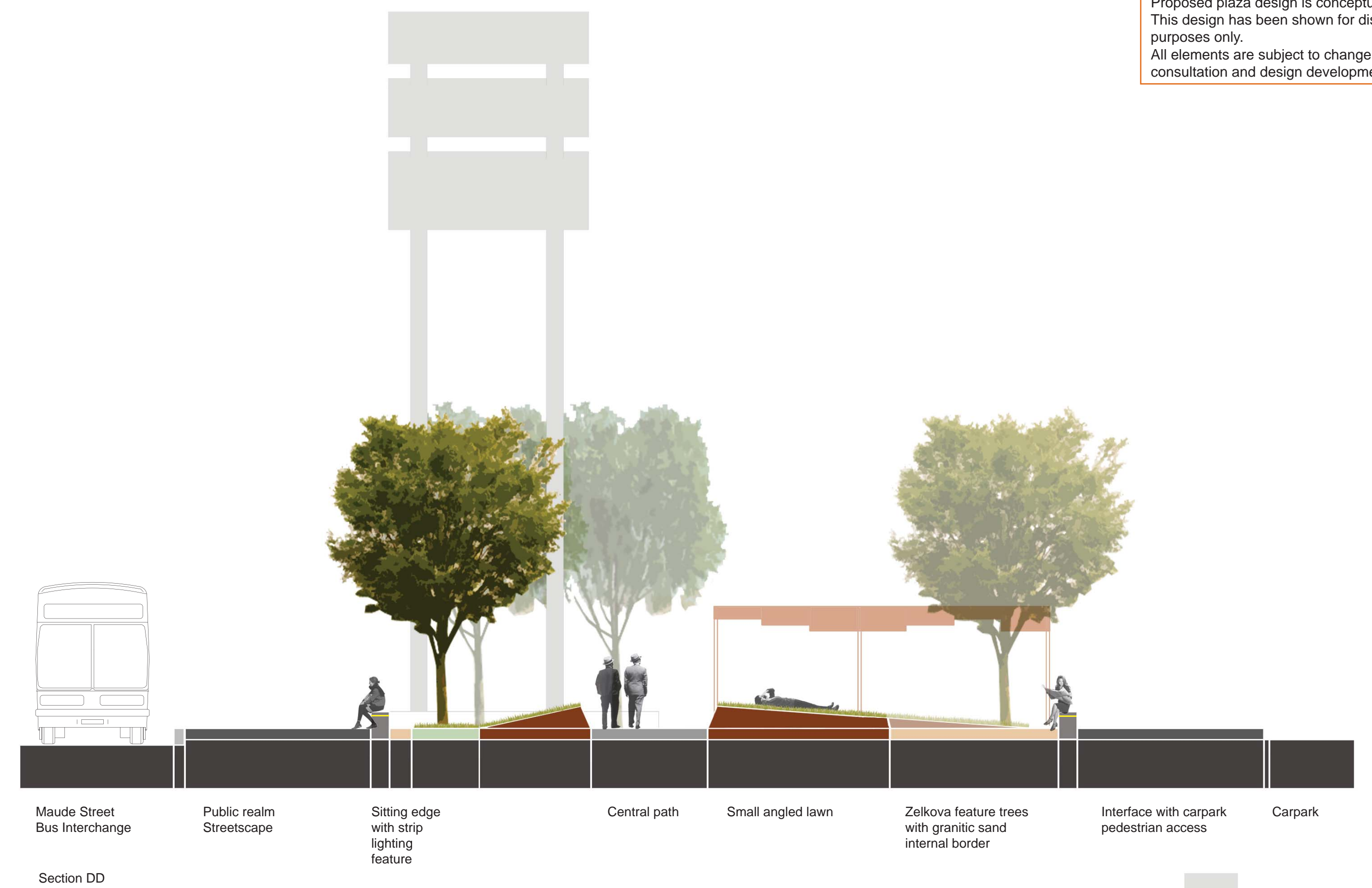
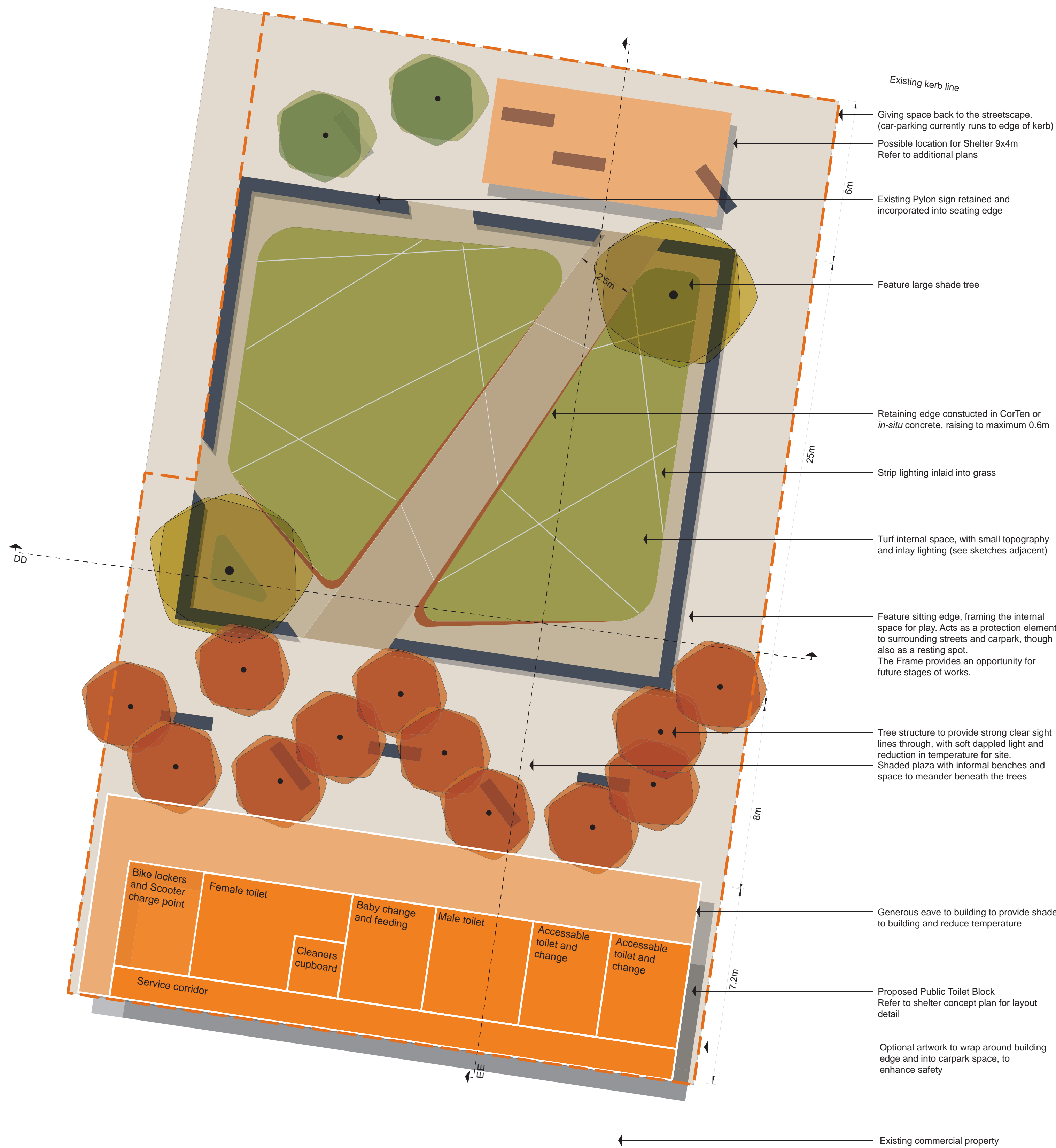

liesi malan landscape architects
level 1 lot 2 bush's lane
bendigo vic 3550
t: 03 5442 253 m: 0427 132 601 e: lm@lmalan.com.au
www.lmalan.com.au A B N : 39 133 179 212

Maude Street Bus Interchange
Greater Shepparton City Council
Plaza Concept Plan

Project number 1050
Sheet No. P_CP_01

Scale 1:100 @ A1

Designed RB LM 10.07.2012
Drawn RB 31.08.2012

© Liesi Malan Landscape Architect ABN 39 133 179 212
THIS DOCUMENT IS COPYRIGHT AND MAY ONLY BE USED FOR THE PURPOSE FOR WHICH IT WAS COMMISSIONED. UNAUTHORISED USE PROHIBITED. ALL DIMENSIONS AND LEVELS TO BE CHECKED ON THE PROJECT BEFORE COMMENCING ANY WORKS OR SHOP DRAWINGS.
DRAWINGS NOT TO BE SCALED.

